

LOKUMA LB / LU 200 - M + ECO - M

Data

Machine type Series		Turret Stations
LB 200	M	12
ECO ES-L8II	M	12



Disc-type Turret VDI 30

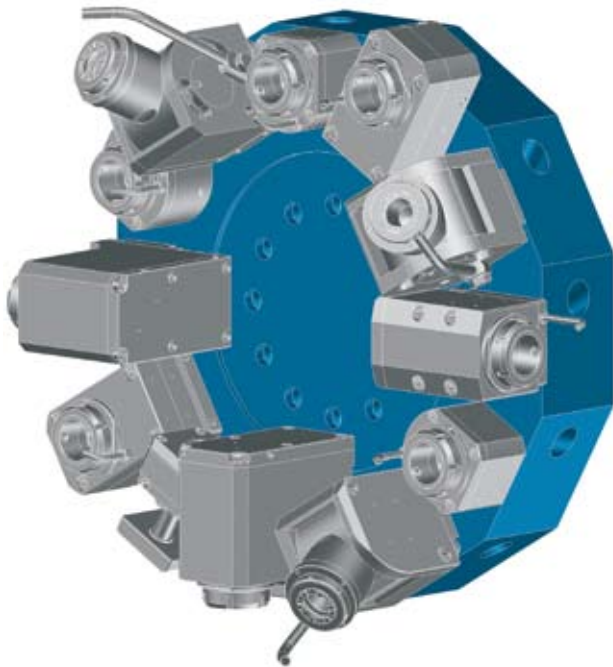

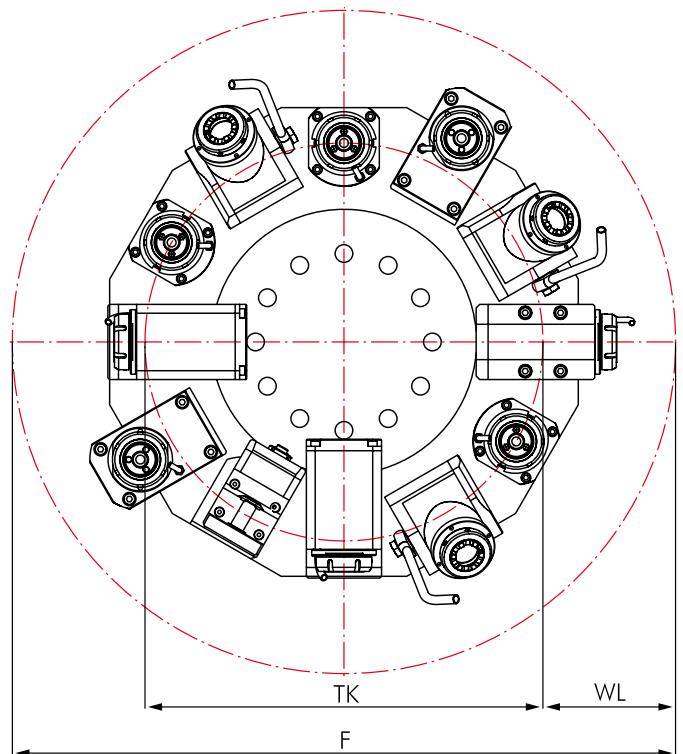

Interference Circles



Machine type Series	F	TK	WL
LB/LU200+ECO	590	310	115

Driven Toolholders

	Page		Page
Straight Unit			158
Angle Unit			159

Options and Accessories

mi Toolholders		mi System Description Toolholders Accessories	275 278-283 283-284
Standard VDI Toolholders		VDI Toolholders Accessories	301-308 309-310
Accessories		Collets DIN 6499 Threading Collets Wrenches Clamping Nuts Sleeves and Bushings	309 309 309 309 310



Straight Unit

for Manufacturer	
LOKUMA	
for Machine type	
LB 200-M ECO ES-L8II-M	
Dimensions	
Revolver type	Disc-type Turret
Shank	VDI 30
Drive	single level
Graduation	30 / 60°

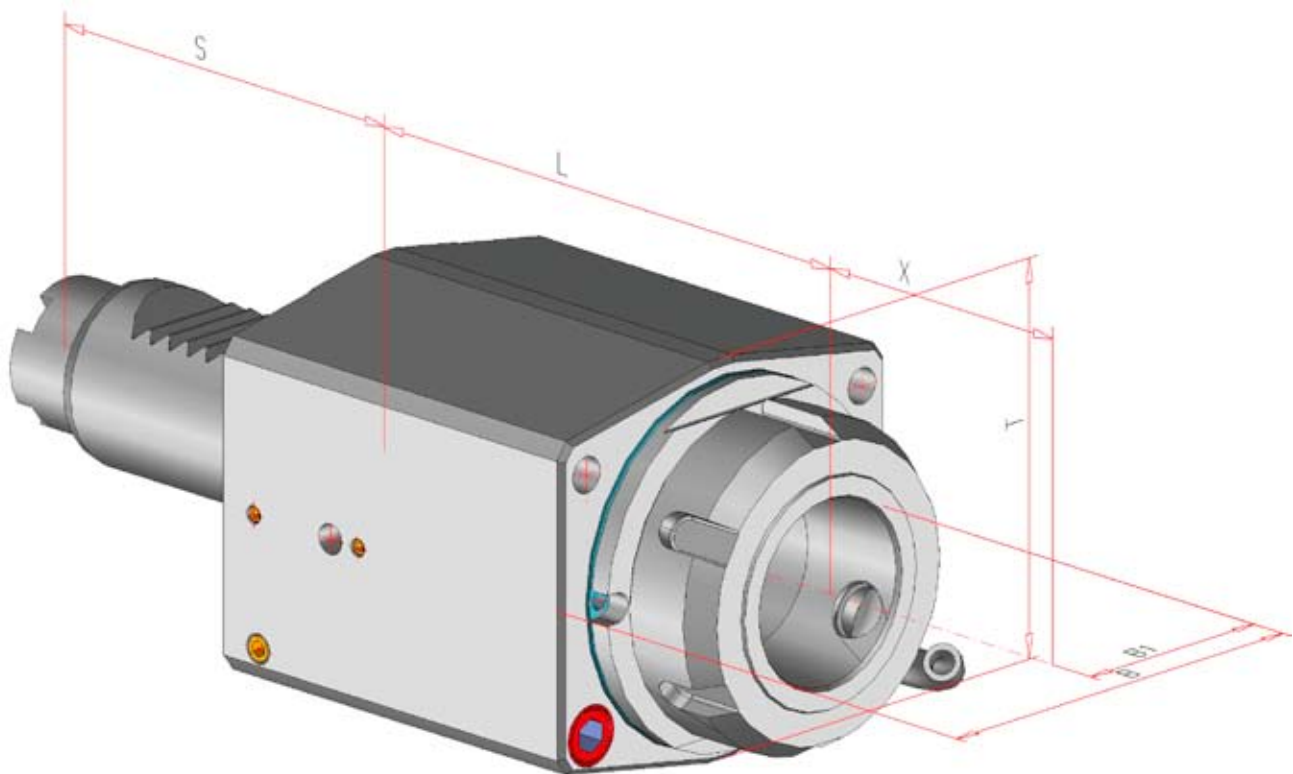

Order No.	Tool holder	Clamping range mm	Torque max.	n1/n2 (max.) (r.p.m.)	Gear Ratio	Coolant	X mm	L mm	B mm	B1 mm	S mm	T mm
133715	ER 25	0,5-16	40 Nm	6.500 / 6.500	i = 1:1	external	-	81	70	35	69	70
133710	ER 25	0,5-16	40 Nm	6.500 / 6.500	i = 1:1	internal	-	81	70	35	69	70
133734	mi 40		40 Nm	6.500 / 6.500	i = 1:1	internal	-	96,5	71	35,5	69	65

Angle Unit

for Manufacturer



for Machine type

LB 200-M
ECO ES-L8II-M

Dimensions

Revolver type	Disc-type Turret
Shank	VDI 30
Drive	single level
Graduation	30 / 60°
Note	no reversion of rotation (drive side direction = output side direction)

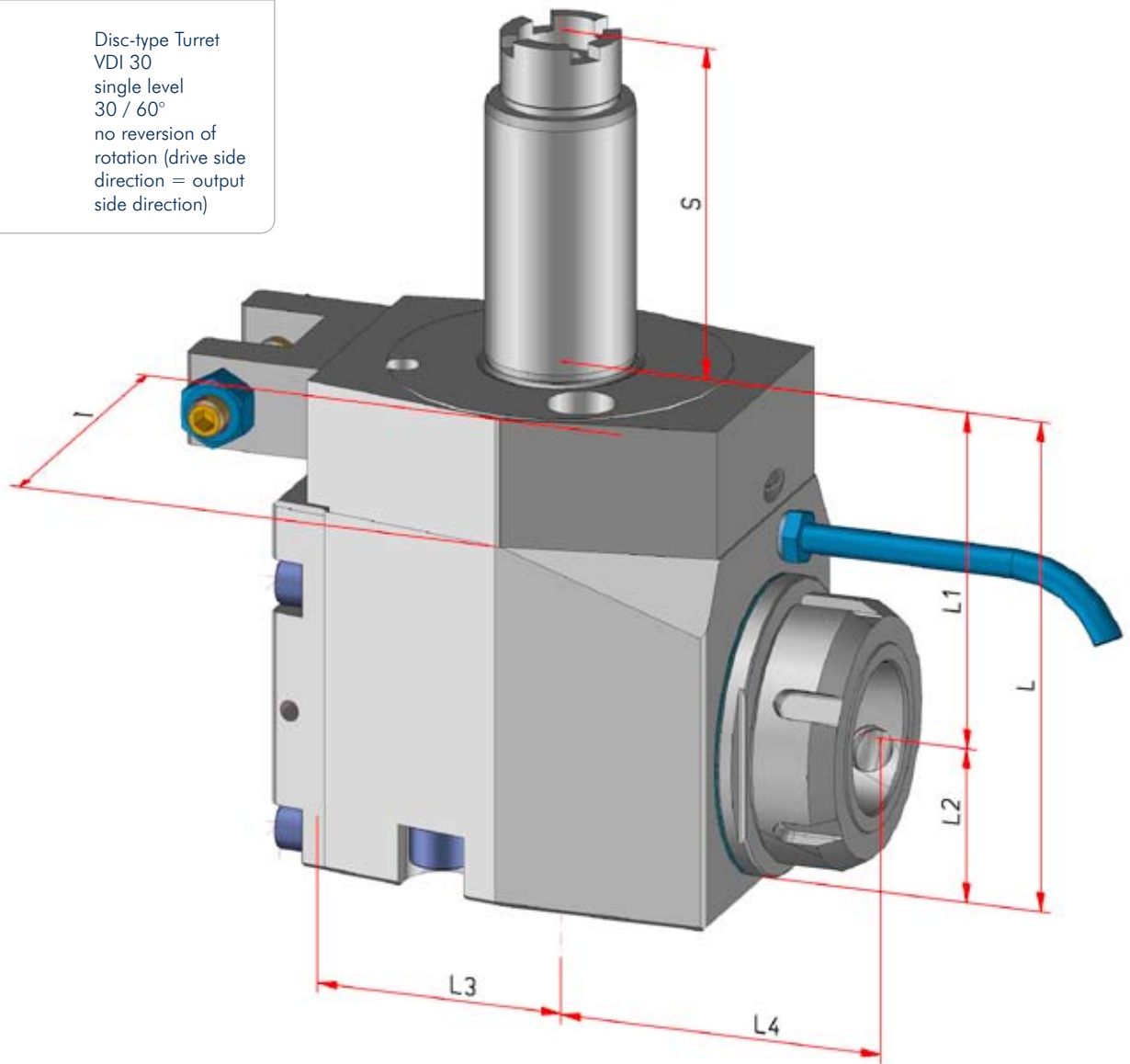

Order No.	Tool holder	Clamping range mm	Torque max.	n1/n2 (max.) (r.p.m.)	Gear Ratio	Coolant	L mm	L1 mm	L2 mm	L3 mm	L4 mm	S mm	T mm
103496	ER 25	0,5-16	30 Nm	6.500 / 6.500	i = 1:1	external	104	70	34	60,5	58	69	76
103520	ER 25	0,5-16	30 Nm	6.500 / 6.500	i = 1:1	internal	104	70	34	60,5	58	69	76
103537	mi 40		30 Nm	6.500 / 6.500	i = 1:1	internal	102	70	32	51	67	69	70